

# Swing Gate

## ASSA ABLOY GS300 Series

**ASSA ABLOY**  
Entrance Systems

Experience a safer  
and more open world



Redirect your people flow with a well-designed, bi-directional swing gate – so your building's private areas can always fulfil their function.

Our new Swing Gate GS300 from ASSA ABLOY is a compact yet sturdy access point solution that helps divert unwanted traffic from non-public areas of your building. Its stainless steel post and tempered glass barrier wing (opened with a DC drive motor) have been proven to stand heavy use, and its swing door mechanism is consistently easy to use by hand.

#### Options and Accessories

- Remote control unit
- Stainless steel post (for opposing side)
- Company logo on barrier wing
- Posts for access control units
- Photocell
- LED indicators under the top lid and barrier wing

#### Design specification

|                            |                         |
|----------------------------|-------------------------|
| Construction               | Stainless steel         |
| Passage width              | max. 1000 mm            |
| Barrier wing length        | max. 900 mm             |
| Post height:               | 1006 mm                 |
| Post diameter:             | 175 mm                  |
| Weight:                    | 40 Kg                   |
| Power Supply:              | 100 - 240 VAC, 50/60 Hz |
| Logic Voltage:             | 24V DC                  |
| Standby power consumption: | 9 W                     |
| Operation Temperature:     | -0 ° / +70 °            |
| IP Protection:             | Cabinet IP44            |
| Opening and closing times: | 1.5 sec                 |

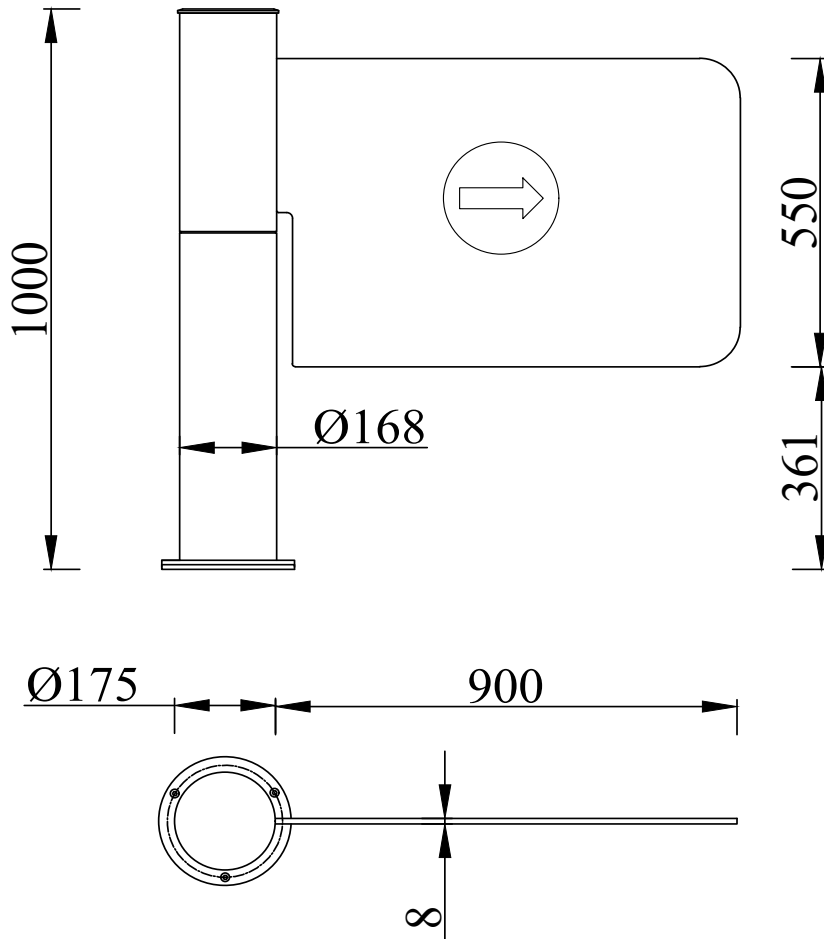

### Customisable settings

The GS300 swing gate turnstile has a logic-controlled interface and operates bi-directionally. Entrance and exit directions can be individually set as controlled, locked, or free rotation. After the adjustable release period, the barrier wing closes the passage fully blocks itself after an adjusted time if no transition or passage occurs. The swing gate also has a permanently open function, and comes equipped with an RS 232 serial port.

### Emergency and power cut modes

In the event of an emergency, the gate unlocks and the barrier wing can swing in the determined direction. During a power cut, however, the mechanism unlocks the barrier wing and it rotates freely in both directions. Once the emergency alarm stops and/or the electricity returns, the gate locks itself automatically.

### Settings

|                                     |                            |
|-------------------------------------|----------------------------|
| Operation mode for each directions: | Controlled / Free / Locked |
| Acoustic notifications:             | On/Off                     |
| Release time out:                   | 5-10-15-20 secs            |
| Emergency connection:               | On/Off                     |
| Sensor-controlled:                  | On/Off                     |
| LED indicator options:              | Option-1/Option-2          |