

Prinzipzeichnung RapidProtect RP300

General drawing Rapid Protect RP300

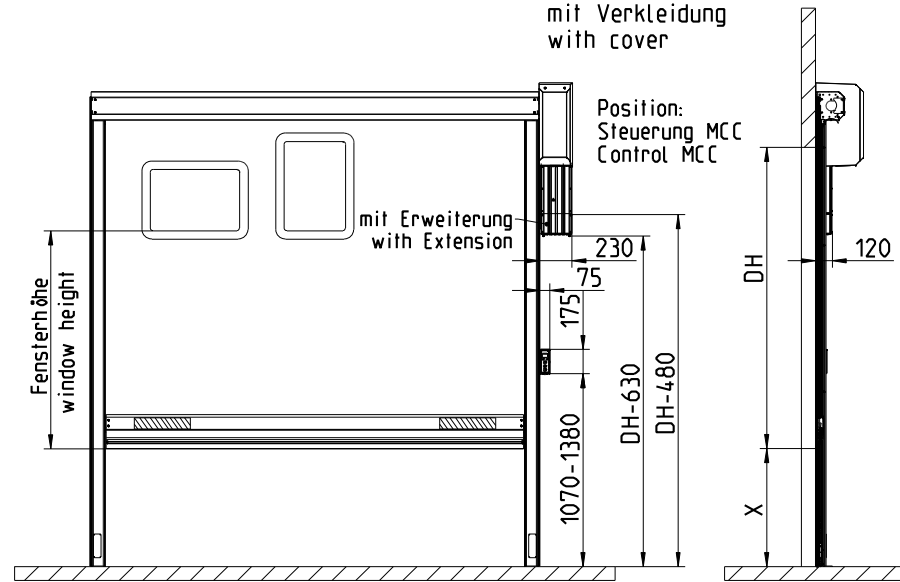

"Option X-Level"
Tor schließt nicht zum Boden, sondern bis auf X-Level
Door does not close to floor, but down to X-level

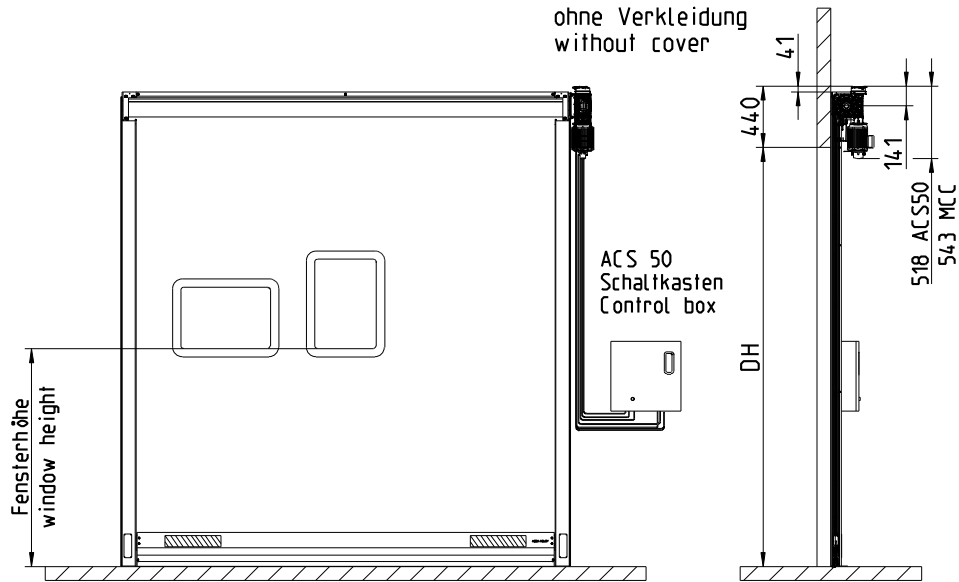
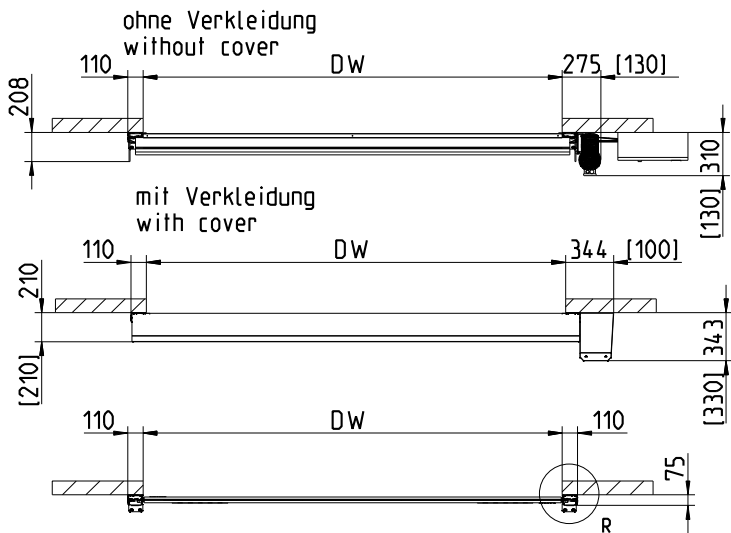

mit Verkleidung
with cover

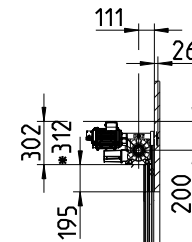
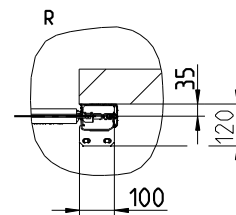
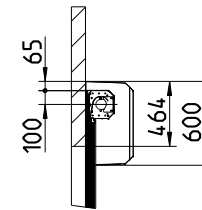

jede 45°
every 45°

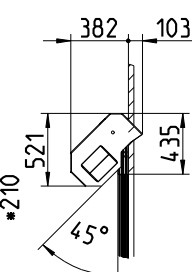

jede 45°
every 45°

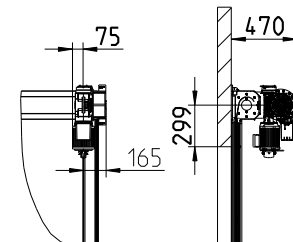

Kettenantrieb
Chain drive

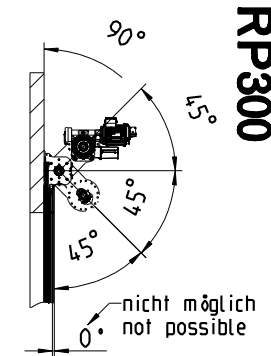

Stütze
Column

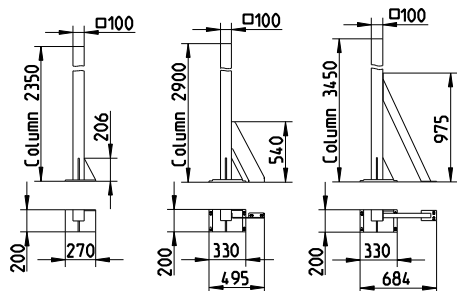

nicht gezeichnete Motor- und Kettenantrieb Positionen auf Anfrage
drive unit- and chain drive position not drawn at request

Toleranz ±3 mm (gültig für alle Maßangaben) Tolerance ±3 mm (for all dimensions)
Maßangaben in [] ==> Montagefreiraum Dimensions in [] ==> clearance for installation

UL-Antrieb
UL-drive unit

9300R0001/e
Stand: 2018-02-15